



General Starting Procedures

This guide will show you what you need to do before and/or during spindle warm-up before you run a program.

Written By: David Paul Farace



Step 1 — Ethanol Level Check



- After starting the spindle warm-up, go to the back of the machine

Step 2 — Canister Check



- Check the canister down to the bottom left and make sure that the clear tube has liquid in it, preferably more than a quarter up from the bottom at least.

Step 3 — Tool Management

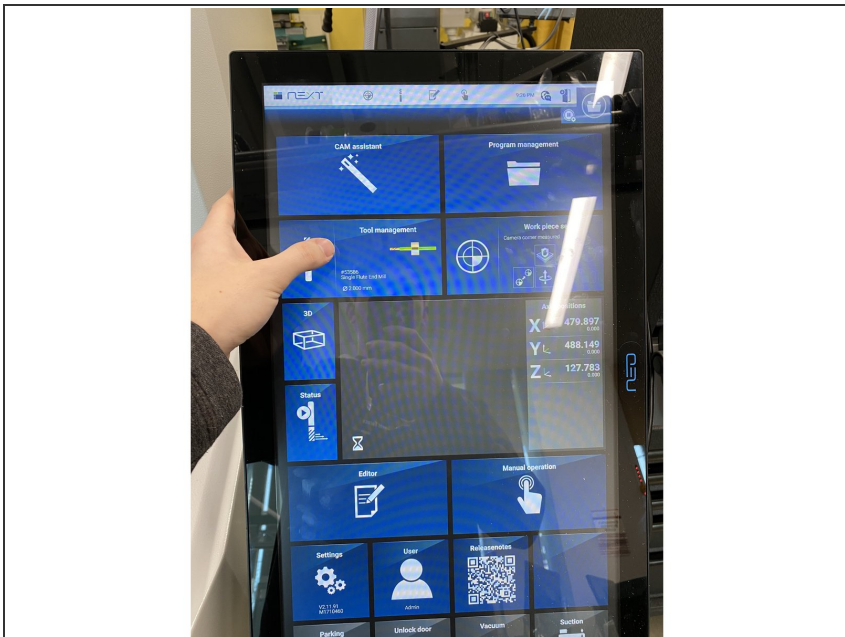

- After that, return to the home screen and click on tool management.

Step 4

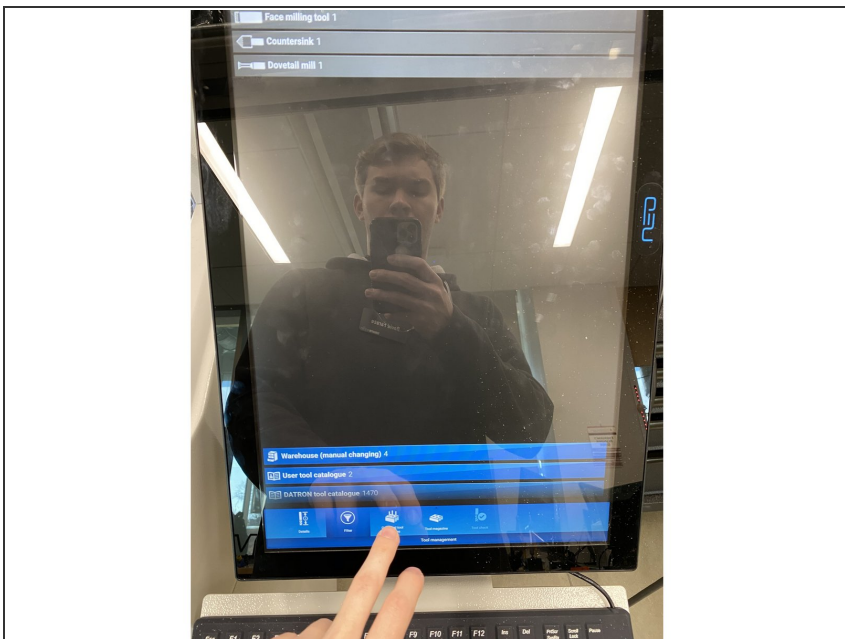

- Once in tool management, click on graphical tool magazine.

Step 5 — Graphical Tool Magazine



- From this screen, you can check to see if all your tools are in the machine before you cut.