



# Track Saw

Written By: Sarah Rosalinde Schaupp



## Step 1 — PPE



- Safety goggles are required to work in the woodshop.
- Ear protection is recommended, but not required.
- Long pants, short/rolled up sleeves, and closed toed shoes are required.
- Long hair must be tied back.

**⚠ NO GLOVES - they can get caught in the machinery.**

## Step 2 — Clamping

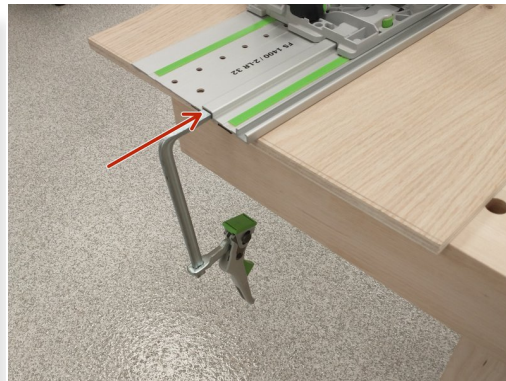

- Lay the track onto the wood you want to cut. The saw will cut exactly where the edge of the track is.
- Insert the clamps into the grooves on both sides of the track, and slide them until they are under the piece and the clamping material.
- Push the clamp up against the surface and pull it back until it is tight.
- Grip the green buttons to release the clamps.

This document was generated on 2022-07-21 08:18:40 AM (MST).



## Step 3 — Adjusting the Angle and Depth

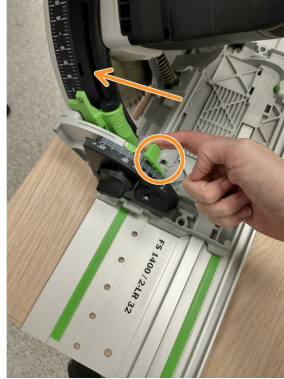

- The track saw can make tapered cuts. To angle the blade first loosen the lock knob on the front of the machine.
  - Pull the indicated lever and push the blade to the side.
  - To raise and lower the depth of cut, push the apparatus towards the measurements and pull it up until the desired depth is indicated.
- i** It is generally best to overhang your piece or put a sacrificial plank underneath it so that you do not cut the table. Make sure to check the depth before you cut.

## Step 4 — Making a Cut

---



- To make cut, press the safety with your thumb and pull the trigger below.
- Move the blade down, then across. When finished with the cut, move the blade back up before turning off the machine.
- When cutting, keep pressure on the blade to maintain an even depth of cut.