



How to set up the machine Pt2: Rolling a bobbin

Written By: Nicholas Ferinde Rabchevsky



Step 1 — Remove Bobbin



- Move the tab to the right, and pry open the clear plastic cover. Then fish out bobbin.

Step 2 — Optional: Remove old tread



- (OPTIONAL) Remove thread from bobbin if it doesn't have the colour you want.
- If it does have the colour you want skip to Part 3.
- If it doesn't have any thread go to the next step

Step 3 — Loading Bobbin

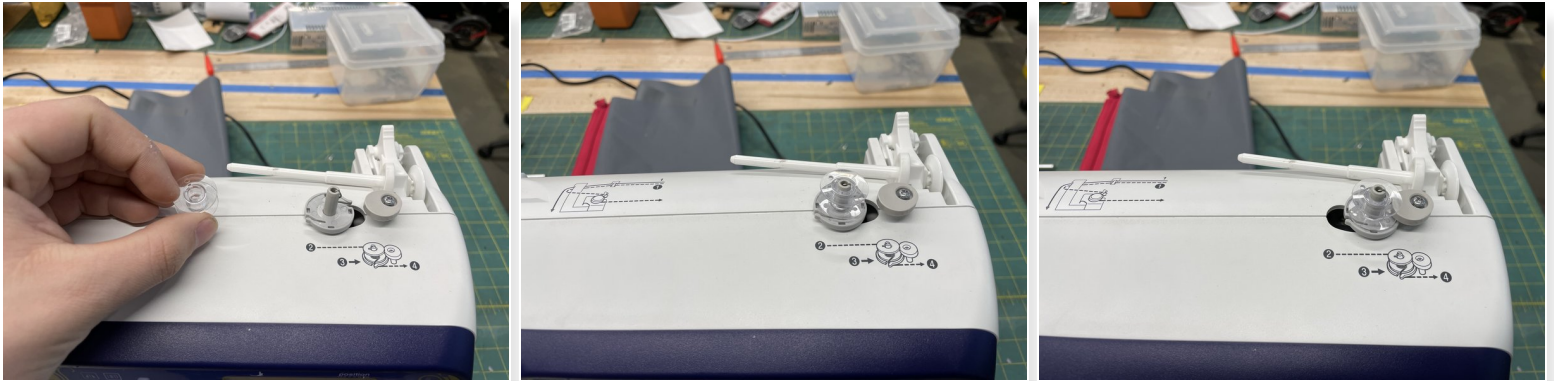

- Place the spool on the grey peg on top of the sewing machine. hen push the entire assembly to the right to engage the system.
- Then push the spool to the right to engage the system

Step 4 — Loading thread

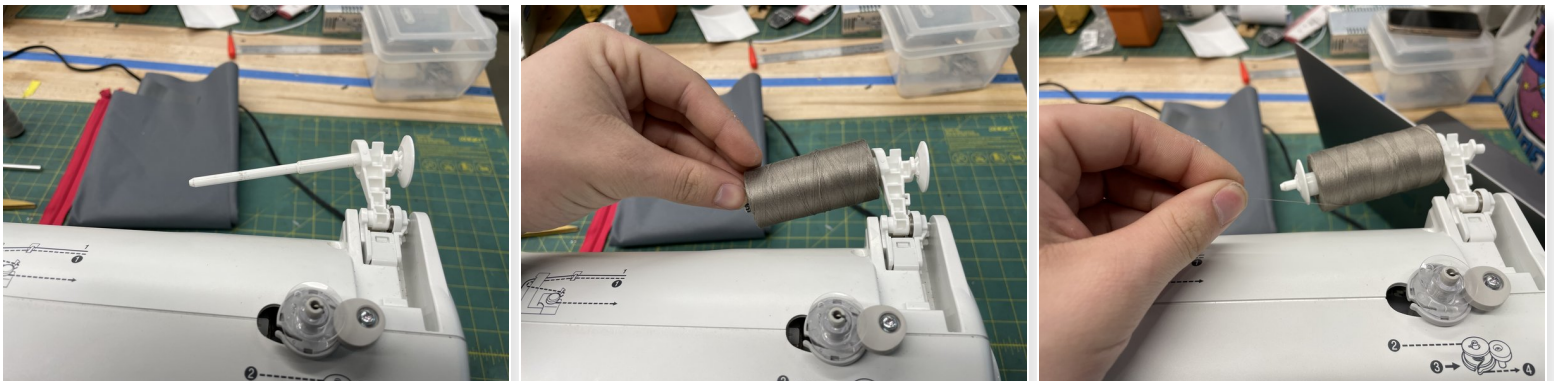

- Open the thread spool holder. you should hear a click.
- Place the spool on the holder.
- Then secure it loosely with the top hat that is kept on the back of the spool holder.

Step 5 — Routing thread Pt. 1

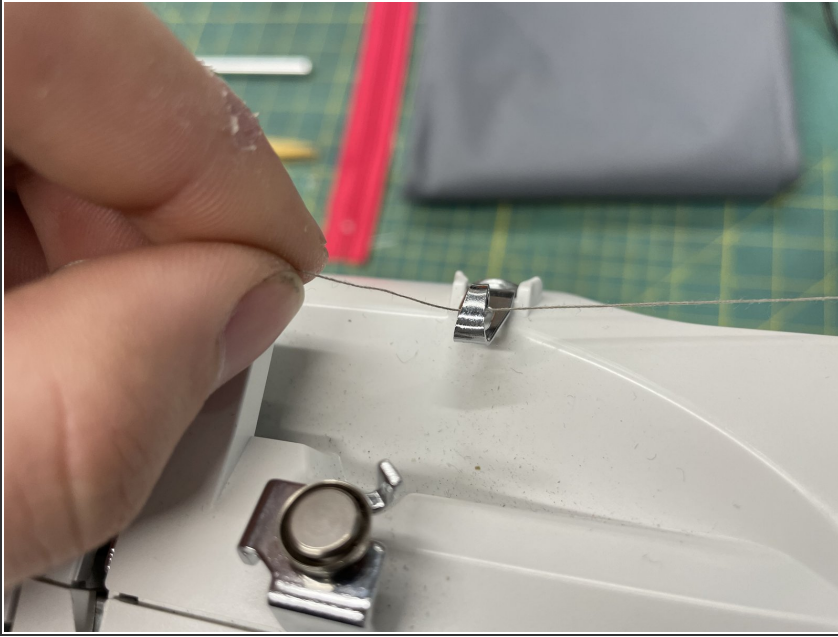

- Route the thread through the system. there is a picture on the top of the machine to show how. (follow the dashed line)

Step 6 — Routing thread Pt. 2



- Insert wisdom here.

Step 7 — Routing thread Pt. 3

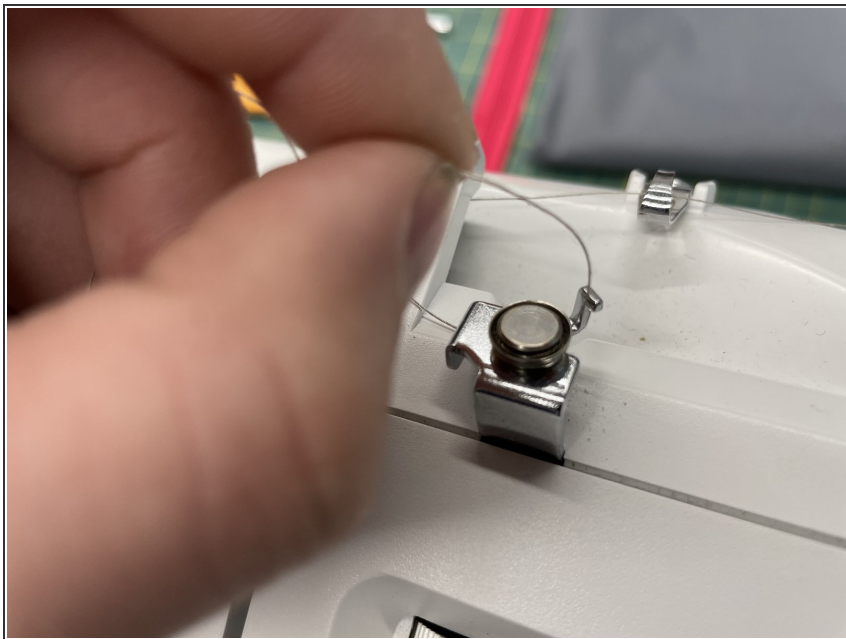

- Insert wisdom here.

Step 8 — Routing thread Pt. 4



- Insert wisdom here.

Step 9 — Routing thread Pt. 5

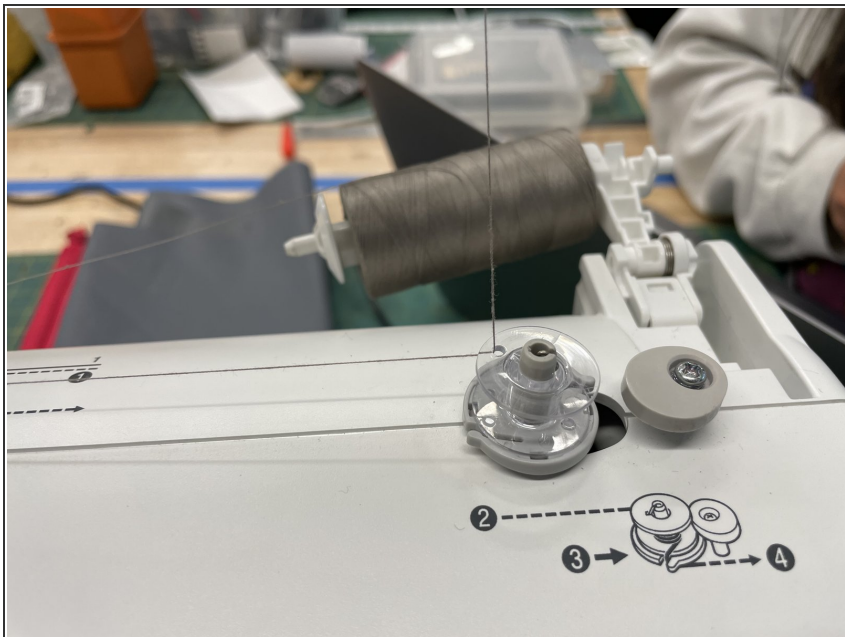

- Thread the thread through the hole. And hold the string vertically.
- Make sure there is a slight amount of tension in the thread.

Step 10 — Step on the pedal



- Slowly press on the pedal to start winding
- Make sure you hold on to the string!!!

Step 11 — Unloading the bobbin

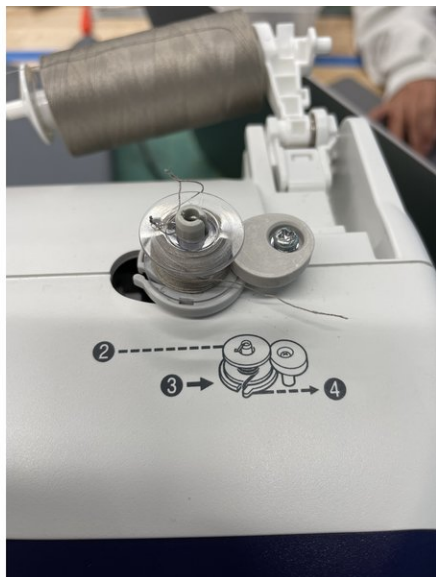

- Unload the bobbin