



Logging In

A how-to on the rather non-intuitive login process for the desktops

Written By: Christian Alexander Torri



Introduction

Man is still the most extraordinary computer of all ~ John F. Kennedy

Step 1 — Logging In



- Before logging in, click the dual-screen icon in the lower right corner

Step 2

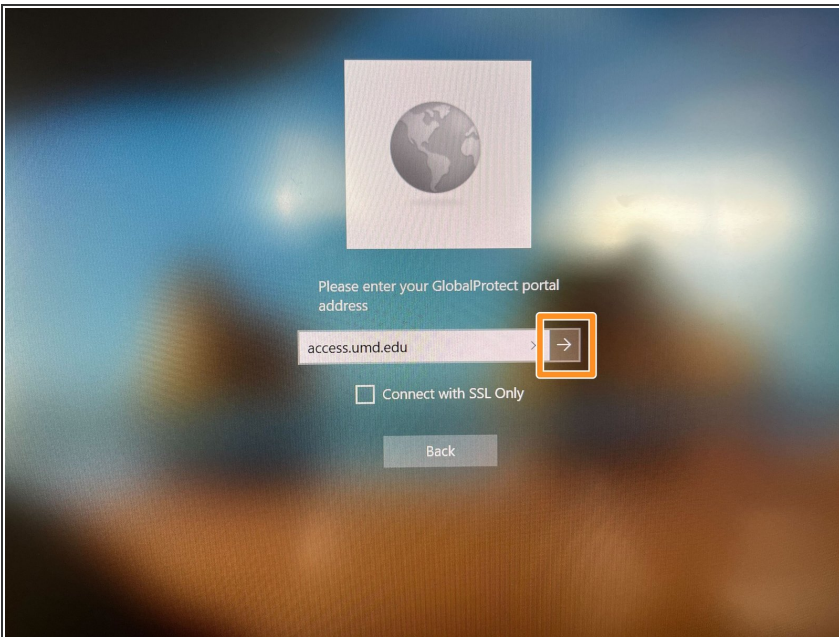

- The field should automatically be filled with "access.umd.edu", if this is not there, retype it
- Click the arrow to move on

Step 3

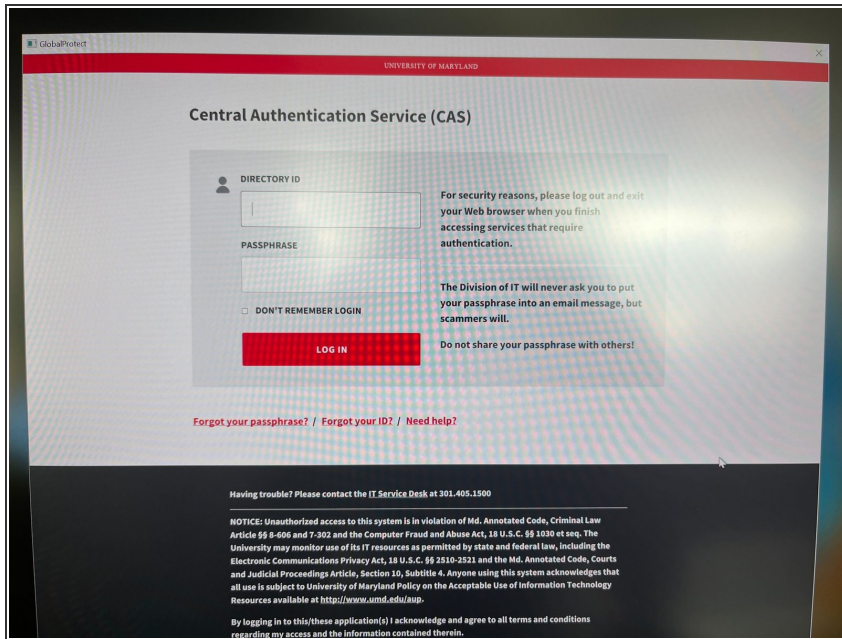

- Use your CAS credentials to log in
- Authenticate the log in via Duo

Step 4

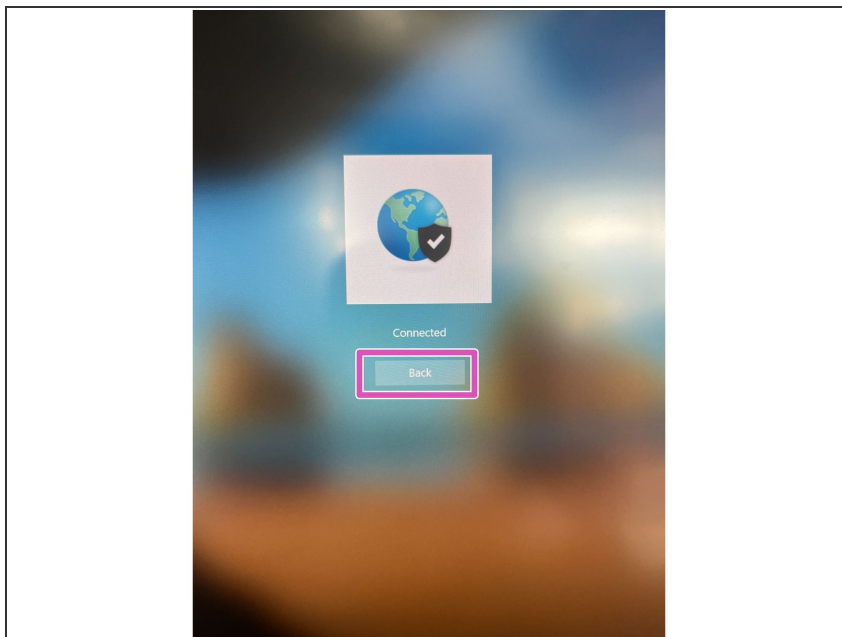

- Click the "Back" button

Step 5

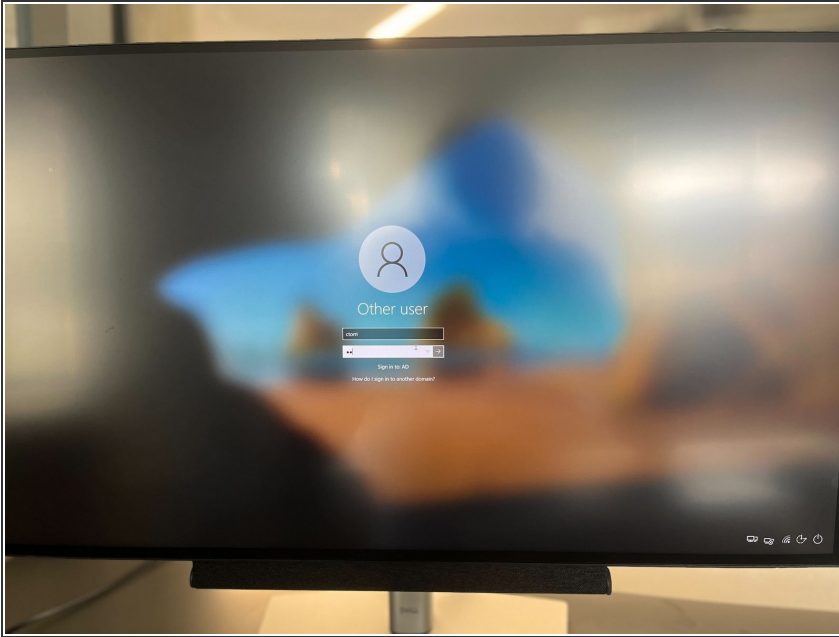

- You may now login once again with your UMD credentials, this time actually logging you into the computer